

# SALVASPAZIO

## SOLUZIONI SALVASPAZIO

Armadio battente con maniglie N18-N17 e pattern su ante P10 Oceano + letto Pedana Soppalco scorrevole + divano letto inferiore Mambo.

*Wardrobe with hinged doors, handle N18-N17 and pattern P10 Oceano + sliding bed Pedana Soppalco + below sofa bed Mambo.*

disegno tecnico:

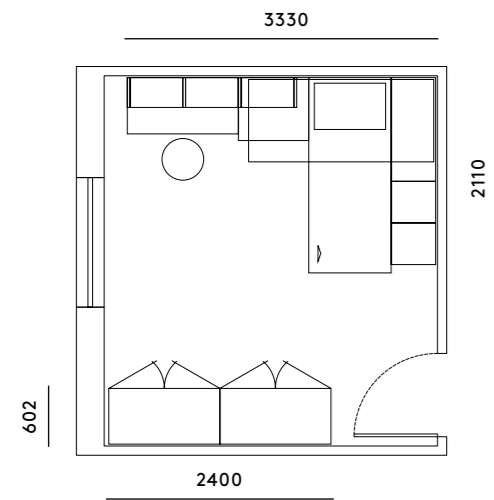

finiture:

bianco

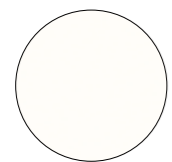

delavè



lavanda

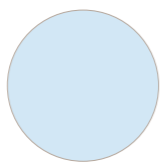

oceano



pattern P10 Oceano

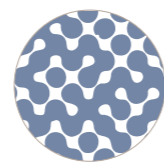



# SALVASPAZIO

Spazio Ragazzi

R28



Sistema scorrevole letto Soppalco. Il letto superiore in posizione di riposo si accosta alla parete, per poi, all'occorrenza, traslare verso sinistra consentendo l'accesso alla scaletta.

*Sliding system bed Soppalco. The upper bed in the rest position approaches to the wall, then, if necessary, move to the left allowing access to the ladder.*

218





# SPACE-SAVING

## SPACE-SAVING ROOMS

Armadio battente aperto, attrezzato internamente di ripiano e tubi appendi abiti. Ante con pattern P10 oceano alternate ad ante in tinta unita.

*Wardrobe with open hinged doors, internally equiped with shelf and hanging rods. Doors with pattern P10 Oceano mixed with doors plain color.*

